

Solutions for Pipe Repair

Reinforcement & Containment

Magic-Wrap



Distributed By :

METAL AID ENGINEERS

G-2, "JAINS BRINDAVAN"

38, BRINDAVAN STREET,

WEST MAMBALAM, CHENNAI 600 033.

TEL. 044-2371 1946, 2471 8292

CELL : 94443 51612

E-mail : metalaidengg@rediffmail.com

*The New Miracle!-
"Instant Repair and
Maintenance
System"*

Product Line



Heat Exchanger

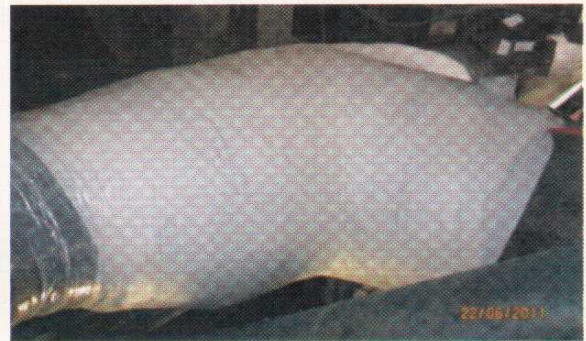

**Magic-
Wrap**

MECHANICAL PROPERTIES

Tensile Strength	ASTM D 638 Type 1-8 Ply	36,448 PSI
Flexural Strength	ASTM D 790 Type 1-8 Ply	26,100 PSI
Compressive Strength	ASTM D 695 Type 1-8 Ply	24,846 PSI
Dielectric Strength		16,060 Volts

Bell & Spigot Repairs Iron and PCCP



Cooling Water Header



CHEMICAL RESISTANCE

Solution	Surface changes	All samples are Tested for 60 days by immersing magic wrap in them.
Sulphuric Acid 50%	None	
Hydrochloric Acid 10%	None	
Sodium Hydroxide 20%	None	
Gasoline	None	

**Magic-
Wrap**

Solutions for Pipe Repair

What is Magic-Wrap?

Magic-Wrap* is the original, easy to use, quick action solution. When properly applied, it will repair damage through everyday wear or when unexpected emergencies occurs.

Magic-Wrap fiberglass cloth is pre-impregnated with a resin which is activated by salt or fresh water. Packaged in a hermetically sealed foil pouch, it's ready to use and does not require any measuring or mixing. This system, when used with the appropriate primary patch, enables you to repair and reinforce virtually any diameter pipe in minutes. Magic-Wrap reduces down time, saving you thousands in parts and labor.

Magic-Wrap is safe to use, non-toxic, non-combustible and odorless. This system can not only restore a pipe to its original PSI rating, but can actually make the repair area stronger than the original pipe.

Applications:

- Corrosion Protection
- Reinforcement of Corroded or Damaged Pipes
- Irregularly Shaped Repairs
- Under Water Repair
- Repairs Pipes from 1/2" to 54"
- Force Mains and Gravity Lines
- Riser Restoration
- Joint and Tee Repair
- Emergency Repair
- NSF 61 Approved for Potable Drinking Water
- Under Pressure Repair

With an initial setting time of only 30 minutes (75°F), Magic-Wrap is excellent on COPPER, STEEL, SS, PVC, CLAY, CONCRETE, RUBBER, and MORE!. It's amazingly versatile.

Number Of Piles	8
Fabrication Method	Wey lay-up
Curing time at 75°F	30 Minutes
Barcol Hardness	5.3



Quick Action

1 Roughen the area



2 Soak Magic-Wrap in water for 20 seconds



3 Wrap in spiral manner

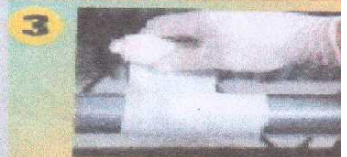

4 Squeeze and mold

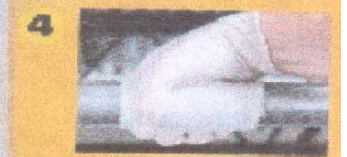

For plugging holes in tanks etc, after soaking in water the tape has to be unraveled and made into a ball and plugged into the opening. Apply continuous pressure against the surface for about 8-10 minutes.



Metal Aid Engineers

G-2, "Jains Brindavan" 38, Brindavan Street, West Mambalam, Chennai 600 033.

Tel. 2371 1946 / 2471 8292 Fax : 2370 1225 Cell : 94443 51612

E-mail : metalaidengg@rediffmail.com

Better Maintenance Products Through Research